



MC-10-80 ILLUMINATED USER MANUAL

Ringsights™

Website www.Ringsights.com

Email info@ringsights.com

Tel +44(0) 1797 226279

The MC-10-80 Illuminated offers the lowest profile for the FN PS90. It is a dual sourced sight with black ring for day and backup electronic illumination for low light.

1. Introduction

The MC-10-80 Illuminated is the latest iteration of the MC-10-80 optic designed specifically for the PS90. The MC-10-80 offers the lowest profile option for a PS90 with a great cheek weld.

The MC-10-80 has a black reticle for day time use with a backup internal electronic illumination for low light. It should be emphasized that even if you don't have a battery you will still have the black reticle to make your shots.

The optic as all of Ringsights optics is parallax free and is solid glass in construction. This offers the advantages of increased ruggedization and no issues with fogging or misting.

The MC-10-80 illuminated has inbuilt electronic switch with 8 different intensity levels including 2 NVG settings. It also has an auto off feature after 2 hours to save on battery life should it be forgotten to be switched off.

The sight is unit powered which means it is designed to be used with both eyes open which improves situational awareness.

MC-10-80 Illuminated

2. Technical Data

Battery	1x CR2032 Battery
Intensity Positions	8 Total (6 Daylight 2 NVG)
Reticle	USSG Reticle
Weight	155 grams
Eye Relief	Unlimited
Waterproof	10m
Temperature	-40°C to +60°C
Envelope Size	130 x 43 x 21mm
Magnification	1x

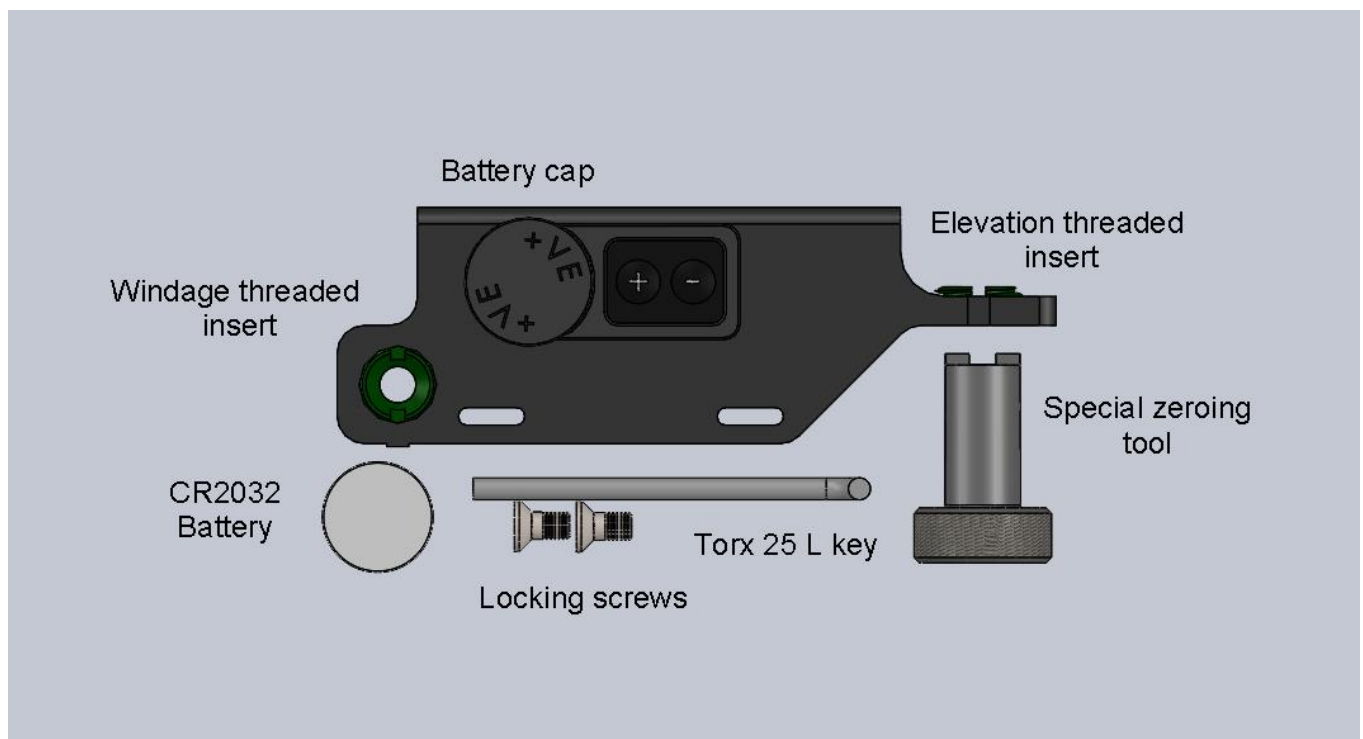

Figure 1 MC-10-80 Illuminated GA

3. Operation and preparation of the sight

3.1 Sight Mounting

To MC-10-80 Illuminated is mounted into the PS90 receiver so doesn't require an extra mount. The sight height was finalized after extensive testing with FN at various different heights. The outcome being what we believe to be the perfect optic height for the PS90 platform.

3.2 Fitting a battery

1. Unscrew the knurled knob on the left of the sight and fit a CR2032 coin cell battery negative end first.
2. Make sure that the threads are clean and the compartment is dry.
3. Screw the battery cap on (taking care not to cross thread) so it is finger tight on the sealing O ring. Ensure the O ring is lightly lubricated with silicon grease.

3.3 Zeroing

Windage: Forward adjuster

1. Loosen the Torque lock screw with the provided T25 L key.
2. Insert the special zeroing tool into the M16 threaded adjuster insert and rotate to change the zero.
3. To move the point of impact to the left rotate clockwise. To move to the right rotate it anticlockwise.
4. An 1/8th turn adjustment of the insert will move the point of impact 100mm at a range of 100m.
5. Once adjusted retighten the torque lock screw with the torx tool provided. Careful not to overtighten or you will risk stripping the thread.

Elevation: Rear adjuster

1. Loosen the Torque lock screw with the provided T25 L key.
2. Insert the special zeroing tool into the M16 threaded adjuster insert and rotate to change the zero.
3. To move the point of impact higher rotate clockwise. To move it lower rotate it anticlockwise.
4. An 1/8th turn adjustment of the insert will move the point of impact 100mm
5. Once adjusted tighten the lock screw with the tool provided. Do not overtighten or you will risk stripping the thread.

3.4 Operation

1. To turn ON the electronic illumination press the +
2. Set the intensity of the sight with the + and – buttons for the required circumstances
3. To turn off the sight press and hold the – button for 5 seconds

3.5 Use with NVG

There are 8 intensity positions controlled with the + and – positions. The NVG compatible positions are the 2 lowest settings.

4. Maintenance

4.1 Cleaning Sight

The 2 optical faces need to be cleaned with care. Use only mild soapy water and a clean cloth.

5. Liability

Ringsights cannot be held responsible for any direct or indirect consequences or damage caused by accidents using this sight. This also applies to every other kind of damage due to the use of this product.

6. Troubleshooter

After changing the battery the sight does not work

- 1) Has a CR2032 coin cell battery been used?
- 2) Has the negative end of the battery been inserted first?
- 3) Are the terminals clean and the cap tightened to the seal
- 4) Are you pressing the + button to switch ON the sight?
- 5) Press the + button 5 times in case it is in NVG mode and can't be seen by the eye.

I have lost or damaged the battery cap O ring

- 1) Replace with a 17 x 1 70 shore nitrile O ring with silicon grease applied.